

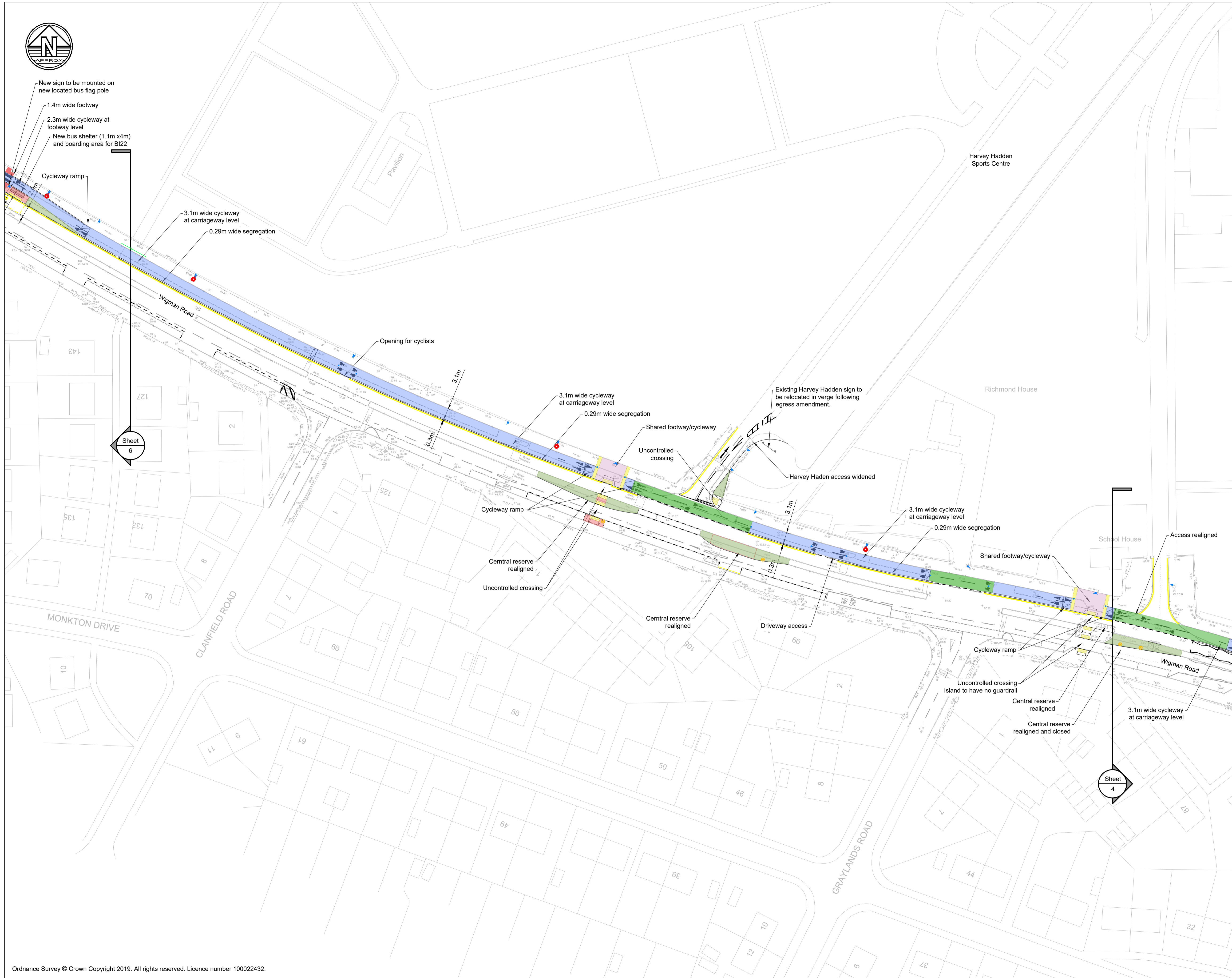

New sign to be mounted on new located bus flag pole
 - 1.4m wide footway
 - 2.3m wide cycleway at footway level
 - New bus shelter (1.1m x4m) and boarding area for B122



Sheet 6

Sheet 4

Notes

1. Do not scale this drawing. All dimensions must be checked/ verified on site. If in doubt ask.
2. This drawing is to be read in conjunction with all relevant architects, engineers and specialists drawings and specifications.
3. All dimensions in millimetres unless noted otherwise. All levels in metres unless noted otherwise.
4. Any discrepancies noted on site are to be reported to the engineer immediately.

Key Plan

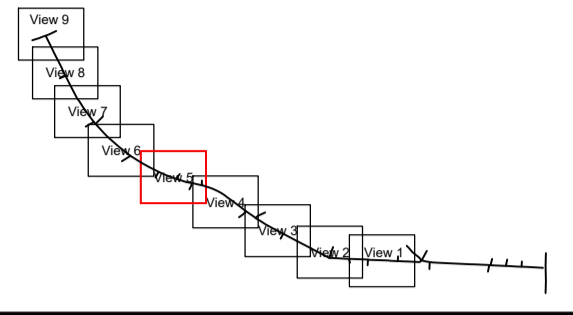

Legend

- Footway
- Cycleway
- Shared Footway/Cycleway
- Soft landscaping
- Blister/tramline paving (Buff)
- Blister paving (Red)
- HFS Cycle Lane (Sherwood Green)
- Pedestrian Guard Rail
- Proposed Sign
- Proposed Bollard
- Proposed Cycle lane Bollard
- Proposed Hazard Rebound Bollard

C01	28.04.23	For Construction	DA	AH
P03	18.01.23	Updated for Approval	DA	JA
P02	16.09.22	Issue for Approval	DA	JA
P01	22.08.22	Preliminary Issue	DA	JA
Rev	Date	Details of issue / revision	Drw	Rev

Issues & Revisions

BWB
A CAF GROUP COMPANY

Birmingham | 0121 233 3322
 Leeds | 0113 233 8000
 London | 020 7407 3879
 Manchester | 0161 233 4260
 Nottingham | 0115 924 1100
www.bwbconsulting.com

Client

Nottingham City Council

Project Title
BEECHDALE CYCLE ROUTE IMPROVEMENTS

Drawing Title
GENERAL ARRANGEMENT SHEET 5 OF 9

Drawn:	D. Ajmal	Reviewed:	J. Ashton
BWB Ref:	220639	Date:	22.08.22
Scale@A1:	1:500		

FOR CONSTRUCTION			
Project - Originator - Zone - Level - Type - Role - Number	Status	Rev	
BRN-BWB-HGN-05-DR-CH-0100	A	C01	