

Qty: 1 Ref: 13-9 Schedule 13 : Temporary Sign	
Qty: 6 Ref: 13-9-RCAO Road Closed Access Only	
Qty: 2 Ref: 13.9 Diverted traffic about right	
Qty: 1 Ref: 13.9 Diverted traffic about right	
Qty: 6 Ref: 2702 Start of temporary diversion route	
Qty: 2 Ref: 2702 Start of temporary diversion route	
Qty: 2 Ref: 2702 End of temporary diversion route	
Qty: 17 Ref: 2703 Direction of temporary diversion route from junction ahead	
Qty: 4 Ref: 2703 Direction of temporary diversion route from junction ahead	
Qty: 3 Ref: 2703 Direction of temporary diversion route from junction ahead	
Qty: 5 Ref: 2703 Direction of temporary diversion route from junction ahead	
Qty: 5 Ref: 2703 Direction of temporary diversion route from junction ahead	
Qty: 10 Ref: 573 Direction to hazard left	
Qty: 10 Ref: 573 Direction to hazard right	
Qty: 13 Ref: 7001 Road works ahead	
Qty: 3 Ref: 7010-FP-13-9 Nature of temporary hazard ahead - Road Closed	
Qty: 13 Ref: 7010-FP-13-9 Nature of temporary hazard ahead - Road Ahead Closed	

VOCON Traffic Management

This Drawing has been produced for a specific client & Project identified below and is not intended for use by any other person or for any other purpose.
© VOCON Traffic Management

NOTES

- All signs as per Chapter 8. Distances between cones to be 9m maximum unless otherwise noted.
- Distances between signs NOT to Scale for purpose of clarity.
- All sign placement subject to available safe working space.
- The purpose of the Traffic Management Plan is for it to be used only as a guide and all traffic management equipment should be put out according to the 'safety at Street Works and Road Works - Code of Practice', i.e. Red Book & the 'Traffic Signs Manual Chapter 8', i.e. Yellow Book

Key

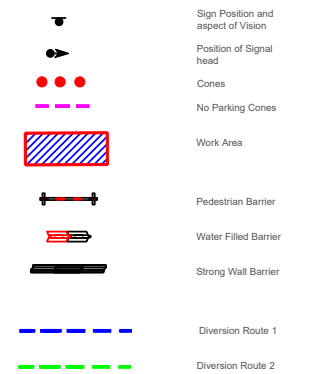

DO NOT SCALE FROM THIS DRAWING -
All Dimensions to be verified on site

B		
A	20/02/23	AS DRAWN
REV.	DATE	DESCRIPTION



Nottingham
Gin Close Way
Awworth
Nottingham
NG16 2TA

Sheffield
342 Coleford Road
Darnall
Sheffield
S9 5PH

Derby
Unit 8,
Stoney Gate Road
Spondon Derby
DE21 7RX

Tel: 03333 448308
www.vocon.co.uk

TRAFFIC MANAGEMENT PLAN

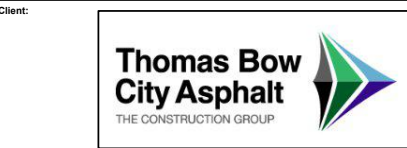

Drawing Number: VJW-009-ThomasBow-20.02.23
Drawing Title:
Phase 2
Wigman Road / Bathurst Drive
Nottingham
NG8 3HS

Name:	Design:	Technical Officer:	REV:
Signature:	V Walker		A
Date:	20/02/23		