

# Path closure notice from 9<sup>th</sup> Feb onwards

As part of the new walking and cycling bridge project, a flood storage compensation area is being created.

To do this safely, the path from Holme Road will be closed and some parking restrictions will be in place on Holme Road to enable machinery and vehicles to access the area. Fencing will be removed (to be replaced once works are complete) and temporary fencing will be provided in the meantime.

A large volume (over 285m<sup>3</sup>) of soil and debris will be removed, requiring up to 40 lorry movements (per direction).

The works are anticipated to last for three weeks, however this could change depending on weather conditions.

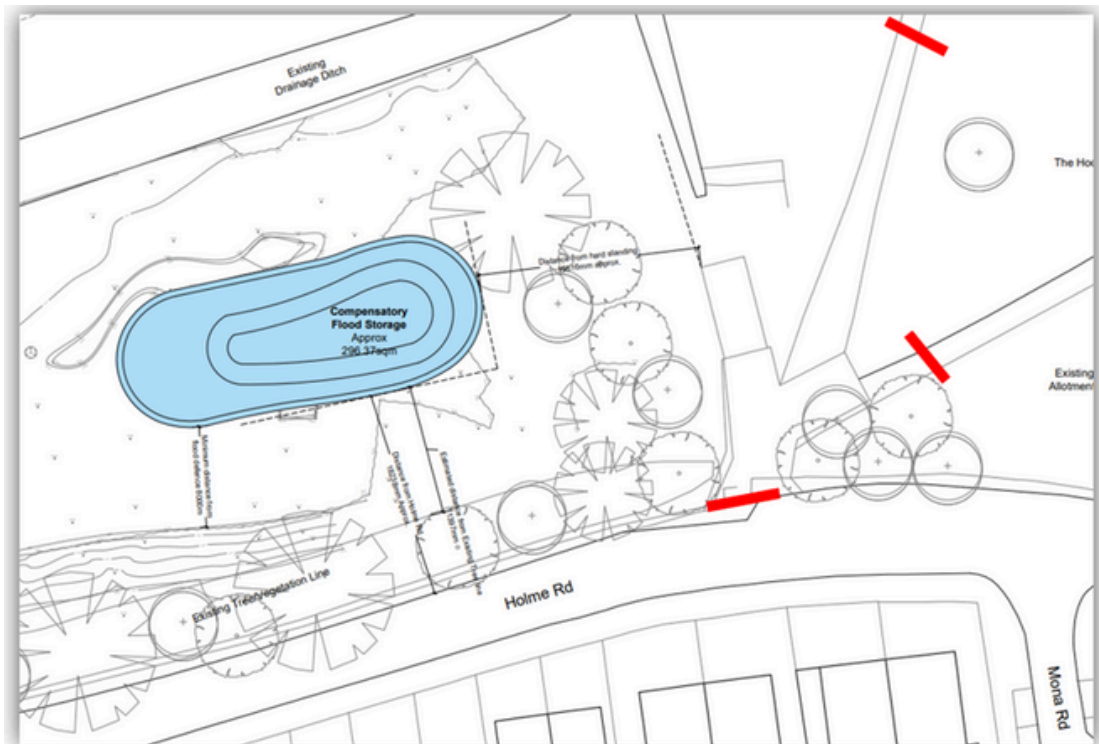

Funded by  
UK Government



Nottingham  
City Council